

# Notice of works

February 2025

The Department of Transport and Planning (DTP) and Yarra Trams regularly carry out maintenance work across the network to improve operations and passenger experience. The tram rails and other tram infrastructure along the St Kilda Light Rail corridor require urgent maintenance so that we can continue to deliver safe and reliable tram services in the area.

## Where?

Works will happen along the St Kilda Light Rail corridor between Whiteman Street, South Melbourne and Fitzroy Street, St Kilda.

## When?

**Early works** will take place each night from **11pm to 5am, Monday 24 February to Thursday 27 February 2025.**

**24-hour main works** will take place from **9pm, Friday 28 February to 5am, Monday 3 March 2025.**

## Early works – what is happening?

- Setting up work areas.
- Unloading rails, ballast and timber sleepers and dragging the rail and timber sleepers to the installation location.
- The site will be made safe each morning.

## Main works – what is happening?

- Setting up work areas.
- Removing old and installing new rails and sleepers in some sections of the corridor.
- Crane lifting the heavy machinery into position.

- Reinstating the site including pedestrian crossing.
- Please follow all signage and instructions from our contractors.

## Early and main works – what to expect

- Vehicles, contractors and heavy machinery on site.
- Mostly low to medium noise levels, with short periods of high noise levels throughout the works.
- Pedestrians will not be able to cross the tram tracks along the corridor. Detours will be in place.
- The pedestrian and level crossings at Bridport Street will be closed during main works, with diversions in place. Pedestrian underpass will remain open.
- Some parking spots along Whiteman Street will be closed to public.
- The entry and exit into Ferrars Place and parking spaces along Ferrars Place will be closed for safety when heavy machinery is being delivered.
- There will be service changes to tram Route 96 during main works.  
Visit: [yarratrams.com.au/service-changes](https://yarratrams.com.au/service-changes)

Works are dependent on weather and subject to change. We appreciate your patience while these works are completed.



For more information about the project visit [yarratrams.com.au/projects](https://yarratrams.com.au/projects) or call **1800 800 007**.

Authorised by the Department of Transport and Planning, 1 Spring Street, Melbourne.

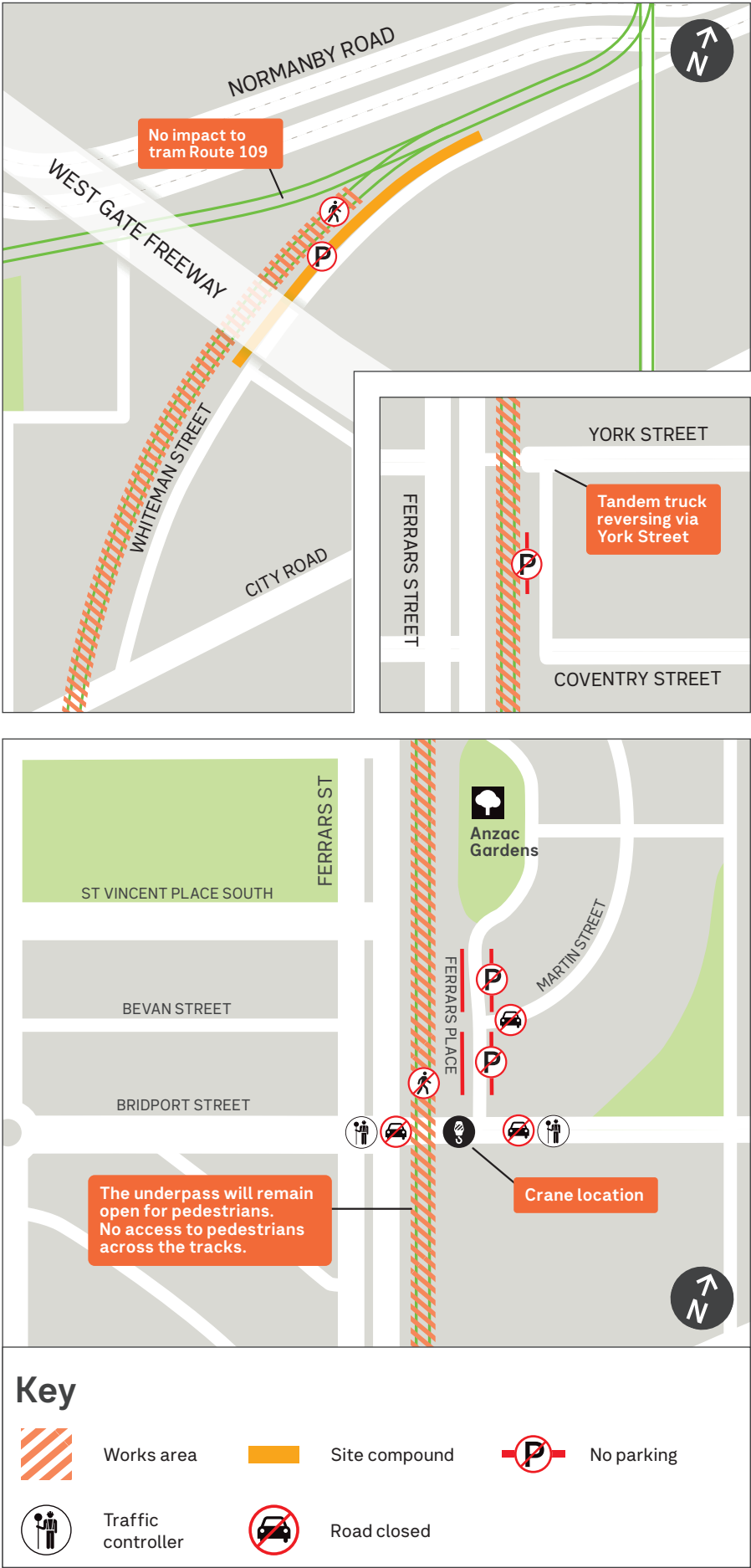
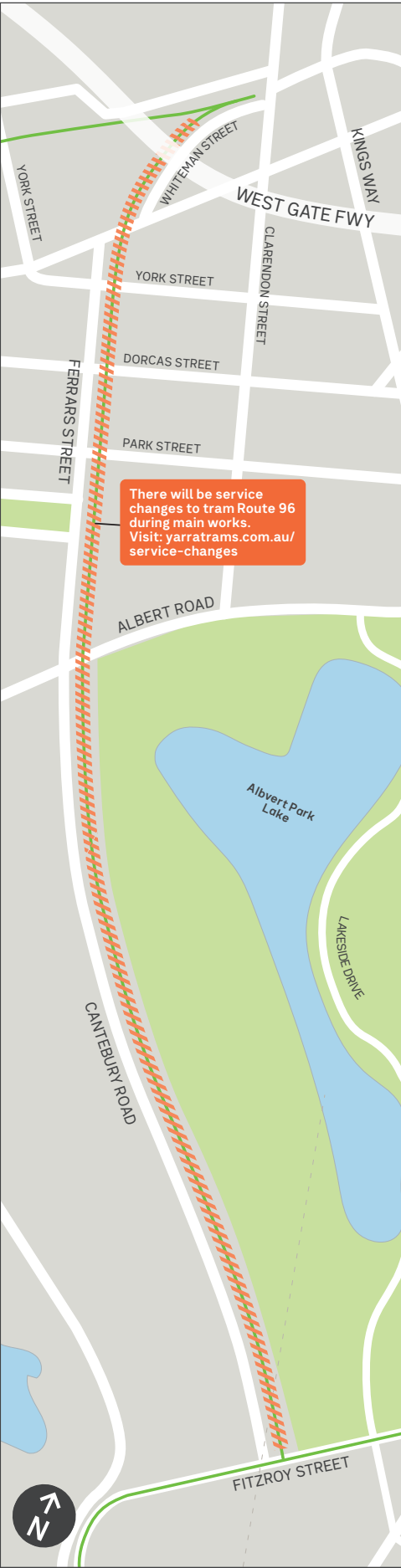

For more information about the project visit [yarratrams.com.au/projects](http://yarratrams.com.au/projects) or call 1800 800 007.

Authorised by the Department of Transport and Planning, 1 Spring Street, Melbourne.

